

Antarctic & South Georgia



Private Charter
“Professor Multanovskiy”
17 November – 8 December 2008

In association with
The James Caird Society
The Royal Geographical Society with IBG
The Society of Old Framlinghamians
The South Georgia Association

Tour Overview

An exclusive private charter of the *Professor Multanovskiy* has been organised by Far Frontiers Expeditions. This is a unique opportunity for like minded travellers to participate in this stunning classic journey from Ushuaia to the Falkland Islands, South Georgia and the Antarctic Peninsula.

We have a very definite view on the style in which we wish to conduct expeditions to Antarctica. There are a whole variety of different ships and cruisers operating in Antarctica today. We consider the choice of ship and style of visit has a significant effect on the experience you may gain. For most people a trip to Antarctica really is the 'trip of a lifetime', so it is vital to get it right. We have specifically chosen our expedition ship for this purpose.

The *Professor Multanovskiy* was built in Finland in 1982-83 for polar and oceanographic research and carries a maximum of 53 passengers in comfortable outside cabins. With an ice-strengthened hull and passive stabilizers it is able to navigate scenic areas for smooth sailing where many other vessels cannot. There will be two highly experienced lecturers/naturalists on board, as well as a ship's doctor, a ship's expedition leader, and a Far Frontiers Expeditions Tour Manager.



The tour is open to members, friends and family of The James Caird Society, The Royal Geographical Society with IBG, The Society of Old Framlinghamians and The South Georgia Association.

The James Caird Society, established in 1994 and a registered charity, is the only institution that exists to preserve the memory, to honour the remarkable feats of discovery in the Antarctic, and to commend the outstanding qualities of leadership associated with the name of *Sir Ernest Shackleton*, especially during the ill-fated but glorious *Endurance* expedition.

The South Georgia Association was formed in 2001 to give voice to those who care for South Georgia, the unique sub-Antarctic island of exceptional natural beauty with wonderful wildlife on land and at sea.

The Royal Geographical Society with IBG is a world leading learned society and professional body that has been advancing geographical science and supporting its practitioners since 1830. It is also a registered charity. Far Frontiers Expeditions is the sole provider of their 'Society Tours'.

The Society of Old Framlinghamians exists to further the interests of Framlingham College, to enable former students to maintain contact with the School and with each other and to encourage links between old boys and old girls of all ages.

Contents

1. ITINERARY	3
2. SHIP INFORMATION	7
3. DECK & CABIN PLANS	9
4. PRICE & BOOKING INFORMATION	13
APPENDIX A Campbell Irvine Insurance Key Points Summary	
APPENDIX B Far Frontiers Expeditions Booking Form & Booking Conditions	



1. Itinerary

Day 1: Depart UK - 17 November

For those who choose our flights, it is likely that there will be a late afternoon departure from London to Buenos Aires. The British Airways flights will travel direct, and the Aerolineas Argentinas flights will travel via Madrid.

IN FLIGHT

Day 2: Arrive Ushuaia - 18 November

This is the southernmost city in the world, a pioneering port town located in the shadow of the Andes and right at the Beagle Channel shore. For those who choose our flights, you will arrive in Buenos Aires and then fly down to Ushuaia this morning.

We will stay tonight in a comfortable hotel, located centrally near shops and restaurants. If you arrange your own travel, you should aim to arrive today.

In the evening there will be an opportunity to sample the local restaurants.

HOTEL B&B

Day 3: Embarkation - 19 November

The morning will be at leisure for shopping or relaxing.

You will be taken from the hotel to the quayside for embarkation which takes place in the late afternoon. Our ship will then set sail through the scenic Beagle Channel.

ON BOARD

Day 4: At Sea

Today we will be at sea en route to the Falkland Islands. In the days ahead there will be many presentations to deepen your understanding of the region – and plenty of opportunities to chat with the Expedition Team in the lounge.

In the Westerlies the ship is followed by several species of albatrosses, storm petrels, shearwaters and diving petrels.

ON BOARD

Day 5: The Falkland Islands

In the Falkland Islands (Malvinas) we plan to spend the whole day on the fascinating western side of the archipelago. On New Island we'll witness how heavy Black-browed albatrosses try to land and take off in a colony they share with the sturdy Rockhopper penguins. A walk along the shore of Carcass Island will give us views of Magellanic and Gentoo penguins, as well as close encounters with water fowl and night herons.

ON BOARD



Day 6: Stanley

In Stanley, the capital of the Falklands, we can experience Falkland culture, which has some South-American characteristics as well as Victorian charm. In Stanley and the surrounding area we can see a number of stranded clippers from a century ago.

ON BOARD

Days 7 & 8: At Sea

At sea, on our way to South Georgia we will cross the Antarctic Convergence. Entering Antarctic waters, the temperature will drop as much as 10 degrees centigrade in a time span of only a few hours. Near the Convergence we will see a multitude of southern seabirds near the ship - several species of albatrosses, shearwaters, petrels, prions and skuas.

ON BOARD

Days 9, 10, 11 & 12: South Georgia

In South Georgia we shall visit the bay of Elsehul, with its very active fur seal breeding beach, and then take a course to Right Whale Bay, Salisbury Plain, Gold Harbour and Cooper Bay to give you a good opportunity to see a wide spectrum of landscapes and wildlife, such as introduced Reindeer, Elephant seals, King and Macaroni penguins. At Fortuna Bay we may attempt to follow in the footsteps of the great British Explorer Ernest Shackleton, and walk over to Størness Bay. There and at Grytviken we'll see an abandoned whaling village, where King Penguins now walk in the streets and seals have taken over the buildings. At Grytviken we'll also offer a visit to the Whaling History Museum as well as to Shackleton's grave near by. One of the highlights might be our visit to Prion Island, where we will witness the breeding efforts of the huge Wandering albatross and enjoy watching their displays.

ON BOARD

Day 13: At Sea

Today we will be at sea, where the ship is again followed by a multitude of seabirds. At some point we might encounter sea-ice. It is at the ice-edge where we might have a chance to see some high-Antarctic species such as the Maccormick Skua, Snow Petrel and the elusive Emperor Penguin.

ON BOARD

Day 14: South Orkneys

We are aiming for a visit to Orcadas station, an Argentinean base located in the South Orkney Islands. The friendly base personnel will give us an idea of the work they are doing and we can enjoy the wonderful views of the surrounding glaciers.

ON BOARD

Day 15: At Sea

Today we travel towards the Weddell Sea.

The Antarctic Peninsula

There will be many unforgettable close-ups in the days ahead, but if you painted the broader canvas of your Peninsula experience it would begin with endless vistas of windswept ice; jagged mountain peaks crowned with snow; massive glaciers descending into the sea; and our ship winding through deep blue waters dotted with floating icebergs.

In addition to all this there is the wildlife: Gentoo, Chinstrap and Adélie Penguins; Weddell, Crabeater and Leopard Seals; Orcas; Humpback and Minke whales; and every kind of bird, from Blue-eyed Shags and Snowy Sheathbills to Kelp Gulls, Cape Petrels and Antarctic Terns.

Day 16: Paulet Island and Brown Bluff

We will sail into the Weddell Sea through the ice-clogged Antarctic Sound. Huge tabular icebergs will announce our arrival to the eastern side of the Antarctic Peninsula. This brings us breathtaking views of snow-capped mountains, cascading glaciers and massive, flat-topped tabular icebergs in crystal blue seas.

On our planned landings you can expect to see every manner of fascinating bird life. We plan to visit Paulet Island with a million pairs of Adelie Penguins and the remains of the Nordenskiöld expedition. At Brown Bluff we can put our feet on the continent.

ON BOARD

Days 17-18: Orne Islands, Paradise Bay, Melchior Islands

On our way west and south we will pass the Orne Islands with their large colonies of Chinstrap Penguins. There will be a beautiful view across the Gerlache Strait or to Cuverville Island, a small precipitous island, nestled between the mountains of the Antarctic Peninsula. It contains a large colony of Gentoo Penguins and breeding pairs of Brown Skuas. From there we sail to Neko Harbour in Andvord Bay and through Paradise Bay with its myriad icebergs and deep cut fjords, and chances of whale spotting.

We will have opportunities for zodiac cruising between the icebergs in the inner parts of the fjords. We sail through the spectacular Lemaire Channel, past towering rock faces and magnificent glaciers, to Pleneau and Petermann Island where we can find Adelie Penguins and Blue-eyed Shags. In this area there is also a good chance of encountering Humpback Whales, Minke Whales and Fin Whales. Sailing north through the Neumayer Channel, we may visit Hannah Point, where we will find a variety of Gentoo penguins, Chinstraps and southern Giant Petrels, as well as Elephant Seals hauling themselves out on the beach.

At Deception Island, we will try to land at Baily Head which is home to a colony of ten thousands of Chinstrap Penguins. Deception itself is a sub ducted crater, which opens into the sea, creating a natural harbour for the ship. Here we find hot springs, an abandoned whaling



station, thousands of Cape Pigeons and many Dominican Gulls, Brown and South Polar Skuas and Antarctic Terns. Wilson's Storm Petrels and Black-bellied Storm Petrels nest in the ruins of the whaling station in Whalers Bay. Good walkers may trek from Baily Head over the ridge of the crater into Whalers Bay, while our ship braves its entrance into the crater through the spectacular Neptune's Bellow into the ring of Deception Island. We arrive at the Melchior Islands with their very beautiful landscape, and again we will aim to experience zodiac cruising among the icebergs. We may encounter Leopard Seals, Crabeater Seals and Whales.

ON BOARD

Days 19 & 20: At Sea

As our ship makes the return voyage across the Drake Passage, we are escorted much of the way by an impressive variety of seabirds, including the magnificent Wandering Albatross, as well as Giant and Cape petrels. You'll often spot whales and dolphins en route as well. When not out on deck, you can enjoy more presentations, compare notes and digital photos, or simply relax in the ship's lounge chatting over drinks with fellow travellers. Lively chats continue as the Expedition Team reviews our journey, and invite your perspective on all we've seen and experienced.

ON BOARD

Day 21: Disembarkation - 7 December

We arrive in the morning at Ushuaia and disembark after breakfast. For those who have chosen our flights, we expect to fly back to Buenos Aires, where we will catch our international flight home to London. If not, you will leave the expedition in Ushuaia after disembarkation this morning.

IN FLIGHT

Day 22: London - 8 December

For those who have chosen our flights, we arrive back into London today.



Important Note:

The itinerary is for guidance only. Programs may vary depending on local ice and weather conditions and in order to take advantage of opportunities to see wildlife. Flexibility is paramount for expedition cruises.

2. Ship Information

Small expedition ship, adventure cruising

We offer adventure cruising on our small expedition ship which only carries a maximum of 53 passengers, resulting in a real community feeling on board. In comparison, most cruise ships carry between 100 and 300 people. This seriously affects their ability to drop off zodiacs if whales are spotted, and increases the time taken for the simplest of landings.

We have specifically chosen our expedition ship for this charter. With an ice-strengthened hull and passive stabilizers it is able to navigate scenic areas for smooth sailing where many other vessels cannot.

Specifications

- Staff & Crew: 32
- Passengers: 53 max
- Length: approx 72m
- Breadth: 12.80 m
- Draft: 4.50 m
- GRT: 1,753 tons
- Propulsion: 2 Diesel ME ^ 3,076 hp engines
- Ice Class: UL
- Cruising Speed: 10 knots
- Maximum Speed: 12 knots
- Registered in Russia

Cabins

As this is our private charter, we have exclusive use of the expedition ship which will be fantastic. We will be able to share our experiences with like minded travellers.

There are five types of berth, with sample cabin layouts shown on the next few pages (not to scale). The cabin types are:

- The Amundsen Suite. The Suite has one double bed and one sofa bed.
- Superior cabin with private facilities. These have one double bed and one sofa bed.
- Twin cabin with private facilities. These have one lower berth and one upper berth, except cabins 411 & 421 which have two lower berths).
- Twin cabin with shared facilities. These have two lower berths.
- Triple cabin. This has two lower berths and one upper berth.

All cabin floors are carpeted. Each cabin has a loudspeaker for general announcements and music piped in from the radio room. There is ample storage space under the bed/berths to store most luggage. If not, passengers should alert the cabin stewardess who should be able to store it for the duration of the voyage. Soap and shower gel are available in each cabin.

Leadership

The 'Society Tour' will be accompanied by one of our experienced Far Frontiers Expeditions Tour Managers. While on ship the Captain has ultimate responsibility. On any zodiac landings or cruises the Ship Expedition Leader has full responsibility.

Briefings & Lectures

Regular sessions will be scheduled when the Ship Expedition Leader and staff will update passengers on plans and provide information about landings. Recap sessions offer an opportunity for passengers to recount their experiences ashore and question the staff.

There will be two experienced guides / lecturers on board. A unique lecture series will be provided. An extensive lecture series will cover all features of our voyage and the surrounding environment.

Bar & Wine Service

There is a well stocked bar on board, staffed by a professional bartender, in the late morning, afternoon and evening. All drinks, liquors, spirits and beverages are imported through international ship's chandlers - and every effort is made to maintain reasonable prices. A varied list of good wine and champagne will be available in the dining room and bar.

Climate

Austral summers in Antarctica typically afford mild temperatures. However, crisp, cold sunny conditions can swiftly shift to storms with very cold winds and snow flurries. Travellers must be prepared for rapid weather changes.

Clothing

Active travellers typically own most of the clothing items necessary for a polar voyage. Comfortable, casual clothing is the best choice. Travellers should dress in layers, to ensure warmth and comfort. Additional detailed suggestions will be provided with the General Information Pack.

Dress On Board

In keeping with our expedition atmosphere, the dress code on board stresses informality. Passengers should plan to bring comfortable, casual clothing for all inside activities. Gentlemen may wish to bring a coat and tie, and ladies a cocktail dress for the Captain's Welcome and Farewell parties but this is certainly not necessary.

Expedition Doctor

There is an expedition doctor on board the ship. There is a small medical clinic, stocked with a limited supply of prescription medicines and basic first aid equipment.

Passports

Travellers to Antarctica must carry a passport that is valid for 6 months beyond the return date of the voyage. The passport should have sufficient blank pages available for exit and entry stamps.

Visas

To reach Antarctica, our expedition ship departs from Ushuaia in Argentina. British passport holders do not currently require a visa to travel to Argentina. However, travellers from other nationalities should check to determine whether they will need an entry visa.

3. Deck & Cabin Plans

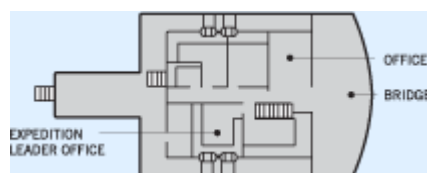

Bridge

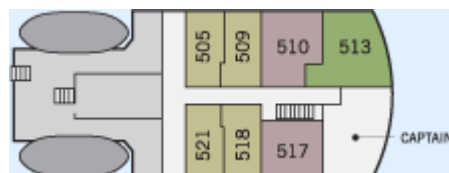

Deck 5



Deck 4



Deck 3



Deck 2

	TRIPLE (SHARED FACILITIES)	2 lower/1 upper berth, shared facilities, cabin sink, opening porthole, desk/chair
	TWIN (SHARED FACILITIES)	2 lower berths, shared facilities, cabin sink, opening porthole, desk/chair
	TWIN (PRIVATE FACILITIES)	2 lower berths or 1 lower/1 upper berth, private facilities, opening window, desk/chair, sofa in some cabins
	SUPERIOR	1 double bed, 1 sofa bed, private facilities, 3 opening windows, table/chairs, TV/VCR/DVD
	AMUNDSEN SUITE	1 double bed, 1 sofa bed, private facilities, 5 opening windows, table/chairs, TV/VCR/DVD

The Amundsen Suite



KEY:

W – Wardrobe, T - Toilet
S – Shower, WB - Wash-basin
C – Chair, R - Refrigerator

1 CABIN: 513

SIZE: 23.2 m² \ 250.8 sq ft
Bathroom 1.8 m² \ 19.4 sq ft

LIVING ROOM: Convertible Sofa Bed: 1.9 x 0.8 m \ 6.2 x 2.6 ft
TV + VCR (PAL System)
Refrigerator
Writing Desk + Light + Bookshelf
Electrical Outlets (European) 220 Volt/50Hz
Table + Chairs
2 Wardrobes
4 Square Windows/Portholes
Large Mirror

BEDROOM: Large Bed: 1.9 x 1.4 m \ 6.2 x 4.6 ft
2 Wardrobes
Beside Cabinet with Drawers
1 Square Window/Porthole

BATHROOM: Toilet (vacuum system)
Shower
Cabinet + Mirror
Wash-basin

Sample Superior Suite

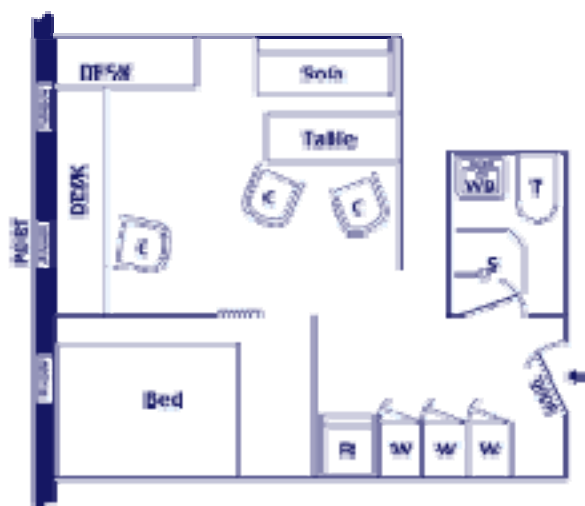

KEY:

W – Wardrobe, T – Toilet, S – Shower, WB - Wash-basin
C – Chair, R - Refrigerator

2 CABINS: 510 & 517

SIZE: 510 = 15.86 m² \ 170.7 sq ft, Bathroom 1.9 m² \ 20.7 sq ft
517 = 19.4 m² \ 208.8 sq ft, Bathroom 1.7 m² \ 18.3 sq ft

LIVING ROOM: Convertible Sofa Bed: 1.9 x 0.8 m \ 6.2 x 2.6 ft
TV + VCR (PAL System)
Refrigerator
Large Writing Desk + Drawers + Light + Bookshelf
Electrical Outlets (European) 220 Volt/50Hz
Table + Chairs, 2 Wardrobes
2 Square Windows/Portholes

BEDROOM: Large Bed: 1.9 x 1.4 m \ 6.2 x 4.6 ft
1 Square Window/Porthole

Sample Twin Cabin with Private Facilities

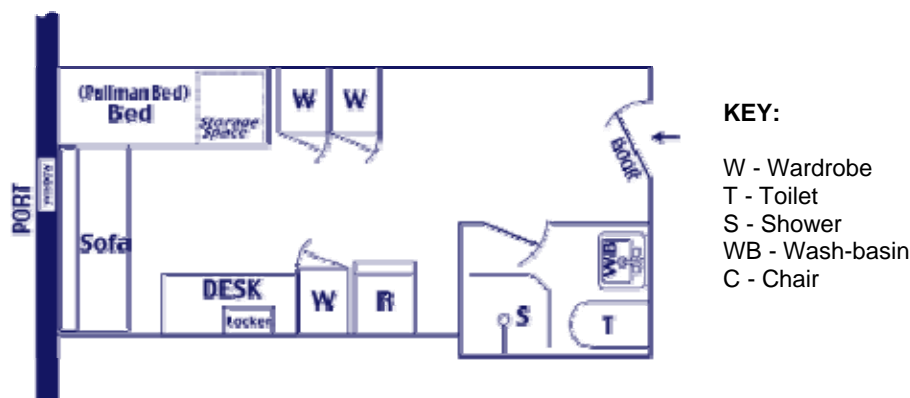

- CABIN:** 1 Lower Berth: 1.9 x 0.8 m \ 6.2 x 2.6 ft
 1 Upper Berth + Ladder
 (With the exception of 411 & 421 which have 2 Lower Berths)
 Sofa + 2 Drawers, Refrigerator, Writing Desk + Light + Chair
 Electrical Outlets (European) 220 Volt/50Hz, Bookshelf, 2 Wardrobes
 1 Square Window/Porthole
- BATHROOM:** Toilet (vacuum system), Shower, Cabinet + Mirror, Wash-basin

Sample Twin Cabin with Shared Facilities

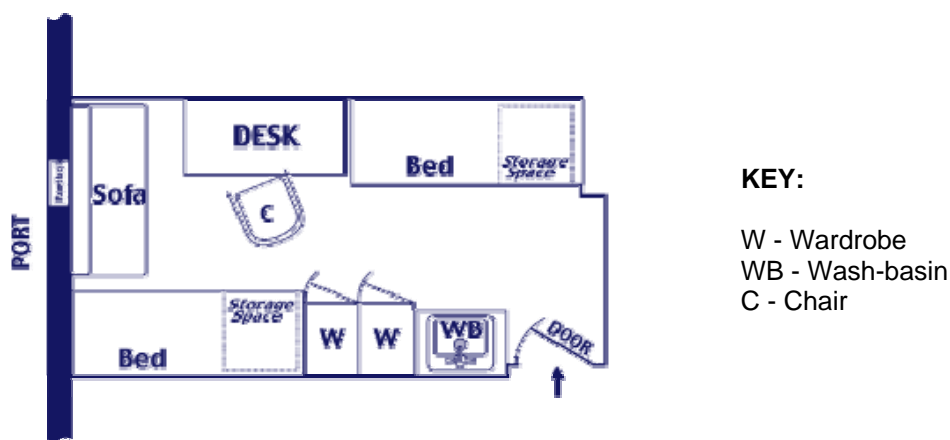

- CABIN:** 2 Lower Berths: 1.9 x 0.8 m \ 6.2 x 2.6 ft
 Sofa, Writing Desk + Light + Chair
 Electrical Outlets (European) 220 Volt/50Hz
 Bookshelf, 2 Wardrobes, 1 Upper Cabinet with Mirror
 1 Lower Cabinet, 1 Window/Porthole, Wash-basin

Triple Cabin as above but 2 lower and 1 upper berth.

4. Price & Booking Information

Expedition cost

Please note that the expedition cost is per person and without flights. When filling out the booking form, use the 'special requests' box to indicate if you require the Amundsen Suite, otherwise please tick your preferred cabin type.

£1,000	Non-refundable deposit payable at the time of booking, in addition to the following balance:
£ 3,993	Berth in a triple cabin with shared facilities
£ 5,245	Berth in a twin cabin with shared facilities
£ 6,475	Berth in a twin cabin with private facilities
£ 7,299	Berth in a superior cabin with private facilities
£ 8,265	Berth in the Amundsen Suite
£ 72	Campbell Irvine Personal Travel insurance premium (if required) <ul style="list-style-type: none"> Premium valid if policy issued before 31 December 2007, after this date subject to 2008 prices to be published Premium doubled if aged 66+

What's included in the expedition cost?

- Expedition Team Far Frontiers Expeditions Tour Manager, Ship Expedition Leader, Expert Lecturers and qualified Ship's Doctor
- Hotel Accommodation on the night of 18 November 2008 in twin share room with continental breakfast, on the night prior to embarkation.
- Berth and meals Full board basis in berth type booked. Meal plan includes breakfast, lunch and dinner plus afternoon snacks; coffee and tea as required
- Voyage All zodiac cruises, harbour and landing fees
- Group transfers Between airport and hotel on arrival and vessel and airport following disembarkation (only for those travelling with inclusive flight arrangements).
Between hotel and vessel for embarkation.

What isn't included?

- Flights International and domestic flights can be organised through Far Frontiers Expeditions or under your own arrangements.
- Fuel surcharges These may have to be passed on if they arise.
- Travel insurance Mandatory personal travel insurance to include full medical emergency assistance and repatriation costs. Can be arranged through Far Frontiers Expeditions with Campbell Irvine as noted in this dossier.
- Immunisation costs Details of those required/recommended will be given in the General Information pack.
- Airport taxes Local departure taxes.
- Ushuaia meals Except hotel breakfast the morning of the voyage
- Clothing Personal equipment and clothing
- Visa fees Currently not required for British passport holders.
- General Items of a personal nature such as: laundry, drinks, telephone, souvenirs etc.
- Transfers Private transfers other than above.
- Tipping Customary tipping for ship's staff.

Flights

We have presented this voyage with flights as a separate cost to give you more flexibility and choice. Fares can vary greatly, and to secure the best price we may book your flight early and ask you for full flight payment at that time. We will be offering three options.

1. For those who wish to travel direct to Buenos Aires with British Airways from London, then down to Ushuaia with an internal flight, we will offer this option. Fares are not published yet for next year, but we expect these to be in the region of £1,750 including transfers.
2. For those who are happy to travel to Buenos Aires via Madrid then down to Ushuaia, we will offer an option to travel with Aerolineas Argentinas. As above, fares are not yet published for next year. However this option is expected to have prices which may be in the region of £1,075 including transfers.

Flights will be available to book towards the end of January 2008, and it is at this time that we will arrange and hold these if you choose to arrange them through us.

3. For those who wish to arrange their own flights - you will need to arrange to meet us at the hotel in Ushuaia on 18 November, and leave us, again in Ushuaia, on 7 December. We will not arrange any other flights than those shown above. Please note that flights fill incredibly quickly, and if you opt out of our flight arrangements the onus is on you to get to Ushuaia. It is unrealistic to plan to arrive in Ushuaia on the same day we sail, so you should plan to arrive a day beforehand as per our itinerary. The expedition ship sails on time without delays.

How to Book

We are expecting early interest in this tour. If you want to join our party it is vital you commit your deposit as soon as possible to secure your berth. You need to sign and complete our booking form, indicating which type of cabin you wish to use, and whether you want to use our flights or arrange them yourself. We cannot guarantee the actual berth you will be allocated but will consider your preferences.

It is important to give us the details of your personal travel insurance policy, or indicate on your booking form that you would like us to request this on your behalf from Campbell Irvine. Please ensure you disclose all defined pre-existing medical conditions. A Campbell Irvine insurance summary document is included at the back of this dossier, and a copy of the full insurance conditions can be e-mailed on request.

Completed booking forms and deposit cheques made out to 'Far Frontiers Expeditions' should be sent to

Jan Short
Far Frontiers Expeditions Ltd
3 The Apple Store, Far Peak
Northleach GL54 3JL

A non-refundable deposit of £1,000 must be paid at time of booking, together with the insurance premium if you wish to take Campbell Irvine Insurance. Interim deposits will be required according to the shipping company's requirements, with the final balance due three months before the voyage.

Photography

All photographs in this itinerary taken by Franco Banfi, Rinie van Meurs or Goran Ehlme